

Specs:

Length: 960mm

Wingspan: 650mm

Weight: TBA

Requires (Recommended):

1 x 2208 – 2212 - 2216 2000KV – 2600KV brushless motor

1 x 20-40A ESC

1 x 1300 - 2200mAh 3S LiPo battery

1 x 5~6inch propeller

2 x 9g servos

1 x 4CH or more Radio TX and RX

Materials:

Motor mount. Contact me for details

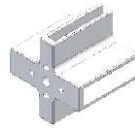

1. A1 Foam board 5mm white

Brand: Larson-Juhl,

\$12 sheet may need preorder, Office Works

Product Code: LJPCFBA1WE

2. Carbon Tube 5.0 x 4.0 x 1000mm, MECT0540

SKU: CFT5

\$8.10 In stock, Modelflight RC

3, Plastic head pins – Lincraft



4, Band saw or mini hacksaw – Bunnings



Construction:

Print the plans – Officeworks

Cut them up and pin to the foam board

Cut out the parts and sand the edges smooth

Assemble and glue. Glue: PVA works well. Reinforce with fillet of hot glue if desired. Use the 3D PDF as a guide

Trimming:

Check the CofG is correct. You may have to add upto 20g to the nose depending of your choice of electrics.

Being a pusher plane, this model experiences a pronounced but manageable propeller-factor (yawing) depending on the direction the propeller is rotating.

Enjoy your flying.

John Roberts